

Parts

| Fig. | Qty | Description | Code | Fig. | Qty | Description | Code |
|------|-----|----------------------------------|-------------|-------|-----|-----------------------------------|---------------|
| 1 | 1 | Jet Inspection Cover | 32376.003 | 35 | 1 | Mixture Screw Spring | 47600.007 |
| 2 | 9 | Screw | 64700.001 | 36 | 1 | Throttle Stop Screw | 64625.015 |
| 3 | 1 | Jet Inspection Cover Gasket | 41550.009 M | 37 | 1 | Pump Plunger | 58602.003 |
| 4 | 1 | Carburettor Cover (50 DCO/SP) | 31734.193 | 38 | 1 | Pump Rod | 10410.015 |
| | | | | 39 | 1 | Throttle Spindle Lock Washer | 55520.004 R |
| 4 | 1 | Carburettor Cover (50 DCO 1/SP) | 31734.194 | 40 | 1 | Pump Rod Spring | 47600.068 |
| | | | | 41 | 2 | Mixture Screw | 64750.058 |
| 5 | 1 | Carburettor Cover Gasket | 41715.011 M | 42 | 2 | Mixture Screw 'O' Ring | 41565.015 M |
| 6 | 1 | Float Pin | 52000.001 R | 43 | 2 | Vacuum Take-Off Cover | 61015.009 |
| 7 | 1 | Float | 41030.034 | 44 | 2 | Pump Jet Gasket | 41535.021 M |
| 8 | 2 | Emulsion Tube Holder | 52580.001 | 45 | 1 | Stud | 64955.007 |
| 9 | 2 | Air Corrector Jet | 77401.160 | 46 | 1 | Pump Spill | 79701.100 |
| 10 | 2 | Emulsion Tube | 61450.091 | 47 | 2 | Pump Jet | 76801.045 |
| 11 | 2 | Idle Jet Holder | 52585.006 | 48 | 2 | Pump Jet Cover 'O' Ring | 41565.009 M |
| 12 | 2 | Idle Jet | 74821.065 | 49 | 2 | Pump Jet Cover | 61015.008 |
| 13 | 2 | Main Jet | 73401.180 | 50 | 2 | Pump Demand Valve Ball | 58300.003 |
| 14 | 2 | Auxiliary Venturi | 68820.500 | 51 | 2 | Pump Demand Valve Weight | 52730.001 |
| 15 | 2 | Venturi (Choke Tube) | 72136.460 | 52 | 2 | Pump Demand Valve Cover | 61015.006 |
| 16 | 4 | Screw | 64840.003 | 53 | 1 | Needle Valve | 79503.250 M |
| 17 | 1 | Throttle Spindle Nut | 34715.017 | 54 | 1 | Needle Valve Gasket | 83102.100 M |
| 18 | 1 | Throttle Lever | 45041.270 | 55 | 1 | Fuel Union Gasket | 41530.031 M |
| 19 | 2 | Air By-Pass Screw Cover | 61030.008 | 56 | 1 | Fuel Union | 10354.019 |
| 21 | 5 | Spring Washer | 55525.010 | 57 | 2 | Fuel Union and Filter | |
| 22 | 5 | Support Bracket Fixing Nut | 34705.004 | | | Cover Gasket | 41530.024 M |
| | | | | 58 | 1 | Fuel Union Bolt | 12715.008 |
| 23 | 1 | Support Bracket Stud | 64955.104 | 59 | 1 | Fuel Filter | 37002.002 |
| 24 | 1 | Bottom Cover Gasket | 41640.066 R | 60 | 1 | Fuel Filter Cover | 61002.010 |
| 25 | 1 | Throttle Shaft | 10020.240 | 61 | 1 | Throttle Lever | 45041.269 |
| 27 | 1 | Inspection Cover Gasket | 41640.065 R | 62 | 4 | Stud | 64955.101 |
| 28 | 2 | Inspection Cover Fixing Screw | 64570.009 | 63 | 2 | Air Horn | 52845.015 |
| 30 | 2 | Throttle Plate | 64005.135 | 64 | 2 | Air By-Pass Screw | 64595.012 |
| 31 | 4 | Throttle Plate Fixing Screw | 64520.027 | 65 | 2 | Progression Hole Inspection Cover | 64590.008 |
| 33 | 1 | Throttle Stop Screw 'O' Ring | 41565.002 R | | | | |
| 34 | 1 | Throttle Stop Screw 'O' Ring Cap | 58000.006 | M + R | | Service Kit | 92.1462.05.01 |

Figure

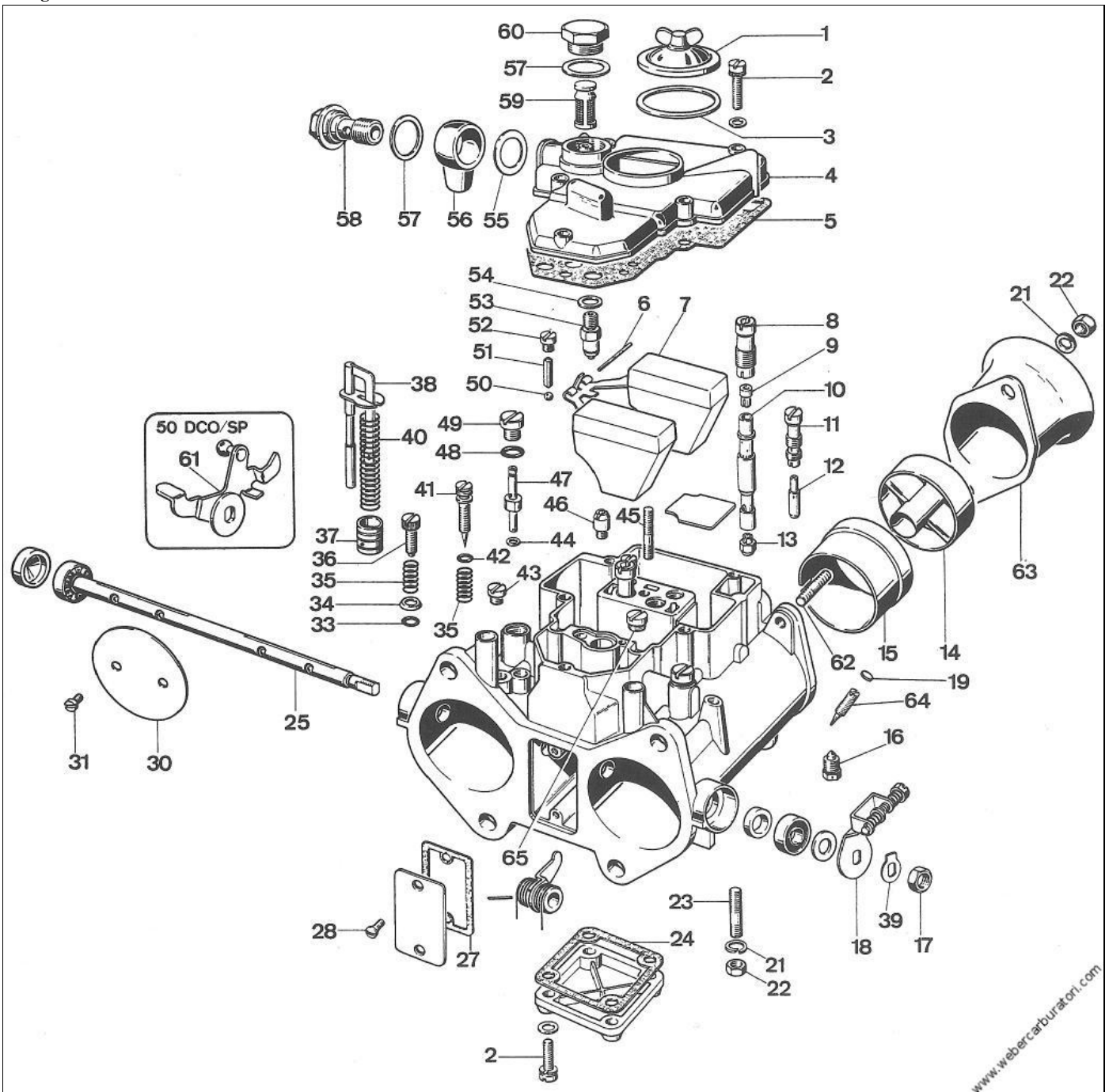

Calibration

| | | | |
|---------------------------|-------|-----------------------|-------------|
| Choke | 46 | Spark Advance Orifice | N/A |
| Auxiliary Venturi | 5.0 | Progression Holes | 100/100/100 |
| Main Jet | 180 | Throttle Plate Angle | N/A |
| Air Corrector Jet | 160 | Needle Valve | 250 |
| Emulsion Tube | F7 | Pump Jet | 45 |
| Idle Jet | 65/F8 | Pump Spill | 100 |
| Idle Air Bush | N/A | Float Level | 12 mm |
| Idle Mixture Orifice/Bush | 135 | Gap | N/A |