

Parts

Fig.	Qty	Description	Code	Fig.	Qty	Description	Code
1	1	Jet Inspection Cover	32376.003	35	1	Mixture Screw Spring	47600.007
2	9	Screw	64700.001	36	1	Throttle Stop Screw	64625.015
3	1	Jet Inspection Cover Gasket	41550.009 M	37	1	Pump Plunger	58602.003
4	1	Carburettor Cover (55 DCO/SP)	31734.195	38	1	Pump Rod	10410.015
				39	1	Throttle Spindle Lock Washer	55520.004 R
4	1	Carburettor Cover (55 DCO 1/SP)	31734.196	40	1	Pump Rod Spring	47600.068
				41	2	Mixture Screw	64750.058
5	1	Carburettor Cover Gasket	41715.011 M	42	2	Mixture Screw 'O' Ring	41565.015 M
6	1	Float Pin	52000.001 R	43	2	Vacuum Take-Off Cover	61015.009
7	1	Float	41030.034	44	2	Pump Jet Gasket	41535.021 M
8	2	Emulsion Tube Holder	52580.001	45	1	Stud	64955.007
9	2	Air Corrector Jet	77401.180	46	1	Pump Spill	79701.100
10	2	Emulsion Tube	61450.030	47	2	Pump Jet	76801.045
11	2	Idle Jet Holder	52585.006	48	2	Pump Jet Cover 'O' Ring	41565.009 M
12	2	Idle Jet	74821.060	49	2	Pump Jet Cover	61015.008
13	2	Main Jet	73401.180	50	2	Pump Demand Valve Ball	58300.003
14	2	Auxiliary Venturi	68820.500	51	2	Pump Demand Valve Weight	52730.001
15	2	Venturi (Choke Tube)	72135.480	52	2	Pump Demand Valve Cover	61015.006
16	4	Screw	64840.003	53	1	Needle Valve	79503.250 M
17	1	Throttle Spindle Nut	34715.017	54	1	Needle Valve Gasket	83102.100 M
18	1	Throttle Lever	45041.270	55	1	Fuel Union Gasket	41530.031 M
19	2	Air By-Pass Screw Cover	61030.008	56	1	Fuel Union	10354.019
21	1	Spring Washer	55525.010	57	2	Fuel Union and Filter Cover Gasket	41530.024 M
22	1	Fixing Screw	34705.004				
23	1	Support Bracket Stud	64955.104	58	1	Fuel Union Bolt	12715.008
24	1	Bottom Cover Gasket	41640.066 R	59	1	Fuel Filter	37022.002 M
25		Throttle Shaft	10020.240	60	1	Fuel Filter Cover	61002.010
27	1	Inspection Cover Gasket	41640.065 R	61	1	Throttle Lever (55 DCO/SP)	45041.269
28	2	Inspection Cover Fixing Screw	64570.009	62	2	Air Horn	52845.015
30	2	Throttle Plate	64005.132	63	4	Stud	64955.101
31	4	Throttle Plate Fixing Screw	64520.027	64	2	Air By-Pass Screw	64595.012
33	1	Throttle Stop Screw 'O' Ring	41565.002 R	65	2	Progression Hole Cover	64590.008
34	1	Throttle Stop Screw 'O' Ring Cap	58000.006				
35	2	Mixture Screw Spring	47600.007	M + R		Service Kit	92.1462.05.01

Figure

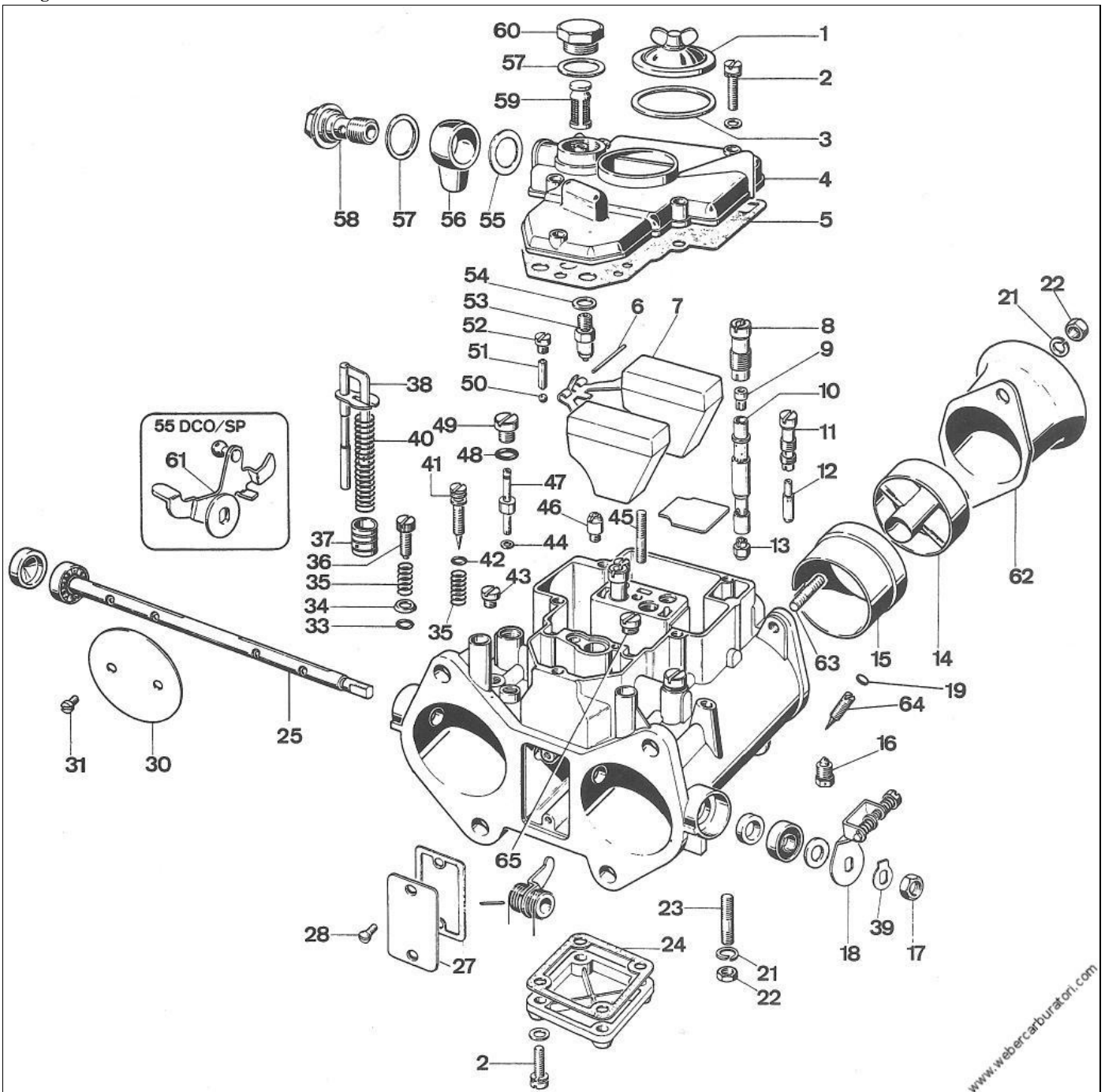

Calibration

Choke	48	Spark Advance Orifice	135
Auxiliary Venturi	5.0	Progression Holes	100/100/100
Main Jet	180	Throttle Plate Angle	N/A
Air Corrector Jet	180	Needle Valve	250
Emulsion Tube	F9	Pump Jet	45
Idle Jet	F8/60	Pump Spill	100
Idle Air Bush	N/A	Float Level	12 mm